

100% variable setting of damper allows for more accurate airflow control, while allowing for nearly true 100% airflow

Side flow baffle reduces airflow when set to 0%

Free hanging design allows for easy retrofit or removal of damper

## SPECIFICATIONS

### General Information

- Material – Extruded Aluminum
- Adjustable from top without removing DirectAire
- Quarter Turn Adjustment for 0-100% adjustment of damper
- Drop in fit onto Tate Steel Bolted Stringer system

## UNDERSTRUCTURE OPTIONS

- 4' Bolted Stringer Steel System

## AIRFLOW PANEL COMPATIBILITY

- DirectAire

Opposed Blade Damper w/24" DirectAire Panel

Static Pressure	100% Open	0% Open
0.02	1060	70
0.04	1485	95
0.05	1670	105
0.06	1810	115
0.08	2100	120
0.10	2490	130



Quarter Turn Adjustment for precise setting of airflow

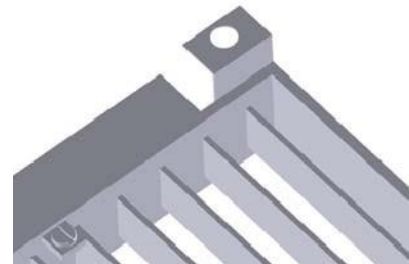

Support Tabs allow for suspension from pedestal head for panel independent mounting, optional screw down mounting